

# LASCA Leaves



Los Angeles County Department of Arboreta and Botanic Gardens

## RENDERINGS OF PLANS SHOW MAJOR ARBORETUM CHANGES

Artist's renderings commissioned by the California Arboretum Foundation show how nine sections of the Los Angeles State and County Arboretum will look after the long

range master plan is implemented. Master plan designers, Jones and Jones, targeted several areas for dramatic changes. An Arboretum gateway and the Peacock Pavilion dining terrace will utilize existing buildings. New structures include

an education building that will house the library and herbarium, a lagoon bridge and a tropical plant shade pavilion.

Landscape architects Jones & Jones were chosen over six competing designers on the strength of the master

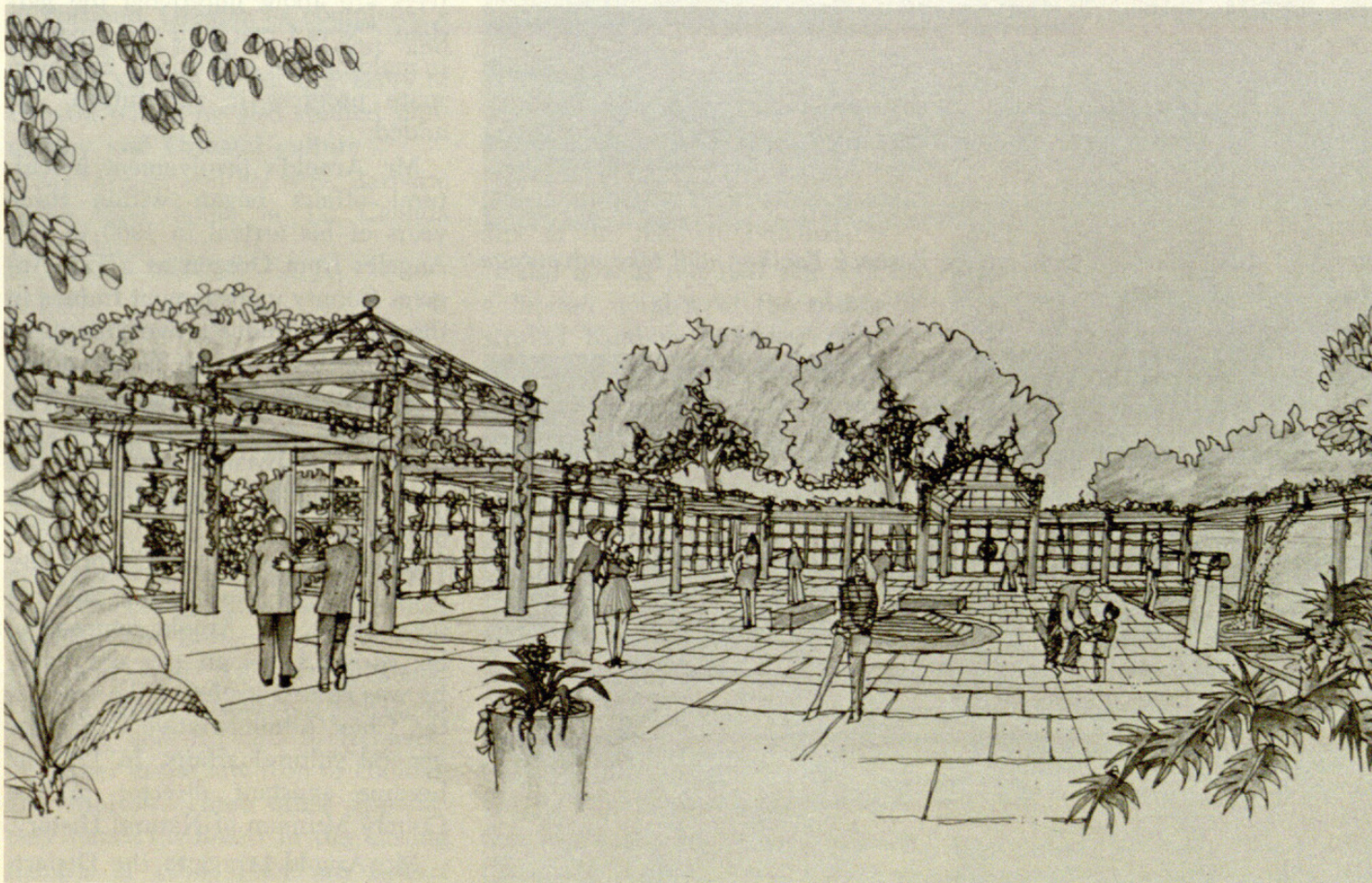

LuAnn B. Munns

*This view of the small entry courtyard shows the gateways that lead to the Garden Festival Green and to the Peacock Pavilion and Tram Ramada. The*

*entrance to the Demonstration Home Gardens is to the right from this perspective.*



plan outline they presented to the Trustees and Francis Ching, director of the Los Angeles County Department of Arboreta and Botanic Gardens.

The nationally known, Seattle-based firm won an award for a design used at Woodland Park Zoological Gardens in Seattle. Jones and Jones has also been involved in planning gardens at the Wild Animal Park in San Diego and the Dallas Arboretum.

## LEON ARNOLD NAMED TO POST BY DIRECTOR CHING

**I**N FEBRUARY, Leon G. Arnold, a veteran of 26 years service with Los Angeles County, assumed his duties as assistant director for the Department of Arboreta and Botanic Gardens. Mr. Arnold replaces Roy Ito who retired in January.

Mr. Arnold, immediate past president of the California Association of Museums, also has served on the

board of directors of the Western Museums Conference, Los Angeles County Management Council and the Western Governmental Research Association.

For the past 13 years Mr. Arnold has been assistant director at the Los Angeles County Natural History Museum. During that time, he has been involved in programs that are similar to those at the Arboretum. The experience Mr. Arnold has had in reviewing grants for the Institute of Museum Services, for instance, will be very useful to the Arboretum.

The Arboretum and the Museum most resemble one another in that both institutions are heavily dependent upon private support groups.

After attending a recent Board of Governors meeting, Mr. Arnold commented on how enthused the volunteers are about improving the gardens. "Now I can lend my expertise in molding that enthusiasm into even more progress in the future," he added.

Mr. Arnold's involvement in cultural affairs began within three years of his arrival in 1960 in Los Angeles from Oregon as a Los Angeles County management trainee in the Chief Administrative Office. In 1963 he became the first County coordinator of the Los Angeles Music Center with responsibility for County involvement through the opening of the Dorothy Chandler Pavilion.

After five years as County-City coordinator of the contract services department, Mr. Arnold returned to his earlier focus on the arts when he was named leader of the team in the Chief Administrative Office for general cultural affairs. In 1973 he became assistant director of the County Museum of Natural History.

Mr. Arnold brings to the Department a longstanding interest in cultural affairs. After earning a bachelor's degree in history and political

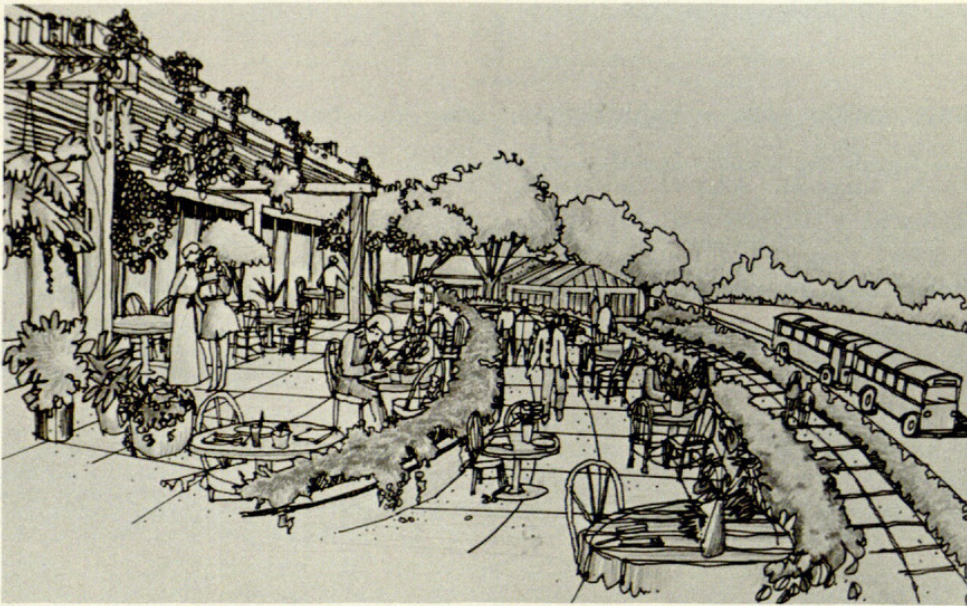

*Proposed dining terraces west of the Peacock Pavilion will take advantage of the panoramic view.*



*A bridge reminiscent of the one painted by Monet will span the Upper Lagoon, bringing visitors closer to the water and plants.*





1987. "Renderings of plans show major Arboretum changes." *Garden* 11(2), 1-2.

**View This Item Online:** <https://www.biodiversitylibrary.org/item/154862>

**Permalink:** <https://www.biodiversitylibrary.org/partpdf/125267>

**Holding Institution**

Missouri Botanical Garden, Peter H. Raven Library

**Sponsored by**

Los Angeles Arboretum

**Copyright & Reuse**

Copyright Status: In copyright. Digitized with the permission of the rights holder.

License: <http://creativecommons.org/licenses/by-nc-sa/3.0/>

Rights: <https://www.biodiversitylibrary.org/permissions>

This document was created from content at the **Biodiversity Heritage Library**, the world's largest open access digital library for biodiversity literature and archives. Visit BHL at <https://www.biodiversitylibrary.org>.